

Deluxe 10 Homecruiser

location guide

Upstairs

- 2 x life rings
- Man over board light
- BBQ
- BBQ – Emergency Shut Off Gas Cock
- Gas bottles (under sink)

Under Rear Stairs

- Battery Change-over switch
- Batteries
- Gas bottles
- Hot Water System
- Hot Water - Emergency Shut off Gas Cock
- Winch – Circuit Breaker

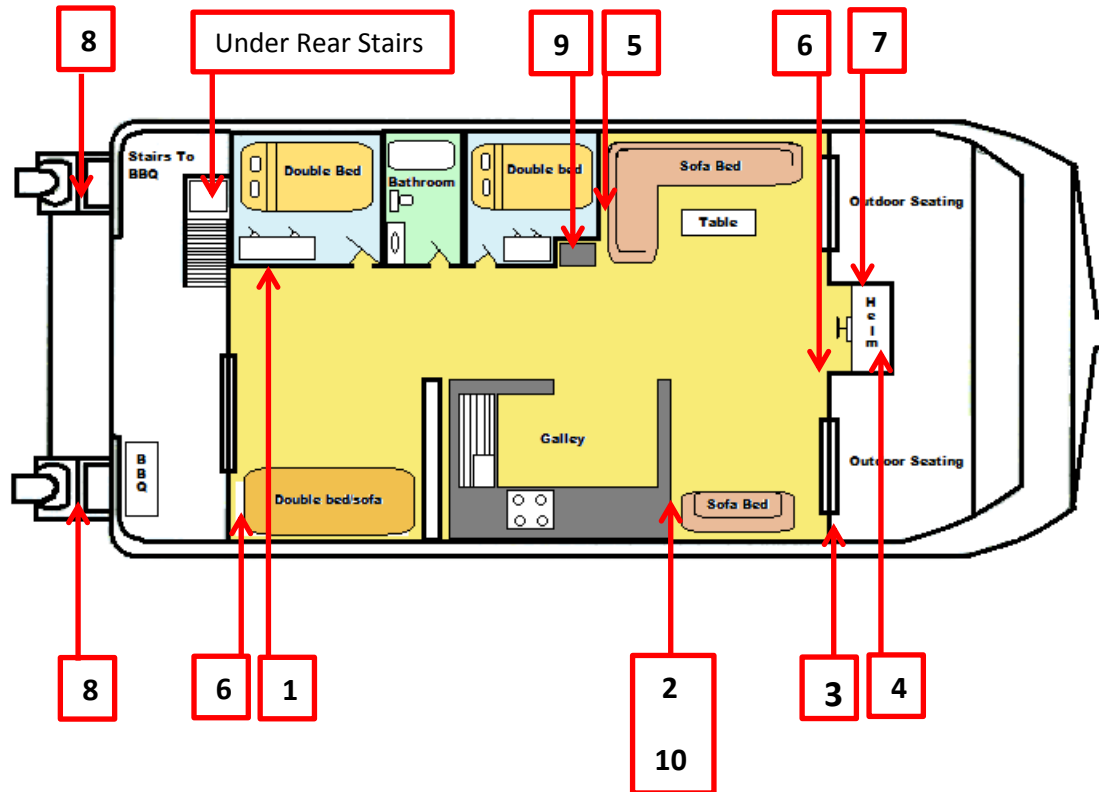

Downstairs

- 1- Main circuit breaker - switch panel (on wall inside)
- 2- First aid kit (in cupboard)
Torch (in cupboard)
Handbook (in cupboard)
- 3- Boat hook (outside – bow of boat)
- 4- Life jackets (under helm)
- 5- Instruction map (on wall)
- 6- Fire Extinguishers x 2 (inside)
- 7- Anchor circuit breaker (helm)
two-way radio (at helm)
- 8- Fuel cocks & fuel bulbs (at motor)

Emergency Shut Off Cocks

- 9- Fridge - Emergency Shut Off Gas Cock (in cupboard above fridge)
- 10- Stove/Cook Top – Emergency Shut Off Gas Cock (in cupboard starboard bow of kitchen)



Hawkesbury Afloat @ BROOKLYN MARINA

45 Brooklyn Road, BROOKLYN
PH: 9985 7722 Mobile: 0408 102614
Email: relax@brooklynmarina.com.au

September, 2018